

## Building Products

# Pre-cast Uniflight Staircases



### Unique pre-cast winding staircase



**Hanson Birchwood has developed a unique pre-cast winding staircase for use in housing developments where there is a need to limit the stairwell plan in order to maximise living areas.**

Uniflight Staircases are ideal for use in town house, multi-occupancy developments, and basements.

Available in L or U shaped configurations, Uniflight includes winders at each turn and features a smooth, curved, high quality soffit capable of taking direct decoration – even in prestigious developments.

Uniflight has been designed to imitate traditional staircase configurations, with the winders radiating round the Newell Post. The design incorporates cut-out sections for Newell Posts.

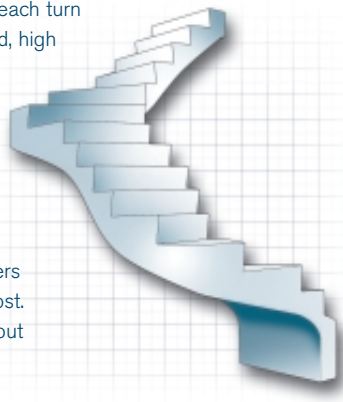

#### Uniflight Benefits

- **Reduced plan area compared to traditional pre-cast solutions.**
- **High quality ex-mould soffit suitable for direct decoration.**
- **Designed to emulate traditional timber configurations with winders radiating round the Newell Post.**
- **Eliminates need for half landings. Simplifies installation and assembly compared to other precast solutions.**
- **Assembled using special adjustable support brackets which are installed into openings in the stairwell.**
- **Staircase can be installed as building progresses.**
- **High level of sound insulation, especially when used in combination with Hanson Birchwood pre-cast floors at upper levels. This combination ensures whole building is sound-proofed from the outset.**
- **Uniflight meets all current Building Regulations, including Part E.**
- **Inherent fire insulation.**
- **Quality-assured factory manufacture.**

## Building Products

# Pre-cast Uniflight Staircases



### Track Record

Uniflight was originally developed for a prestigious 3-storey housing development in London and was designed to provide a concrete version of a staircase originally produced in timber.

Used throughout the development, it proved to be a complete success. Such was the quality of the finish that the developer was able to apply decoration direct to the highly visible soffit in these high specification homes.

### Variations

Uniflight is supplied in a standard width of 890mm. Riser variations from 191 – 195mm are available.

Floor to floor heights to suit most domestic housing applications can be provided.

Additional variations are available subject to minimum order quantities.

### Support

Hanson Birchwood's in-house design team is available to provide expert assistance – including 3D modelling – to help clients achieve the perfect solution.

The team can also advise on the best use of complementary products in the Hanson Birchwood portfolio.

In addition, a comprehensive Uniflight Installation service is also available.

For more information or for quotes please call Hanson Birchwood.

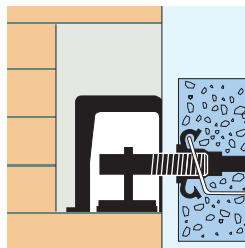

**Adjustable support brackets**

