

Installation guide

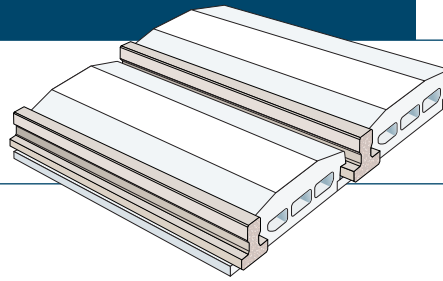

- 1.** Lay DPC and set out first beams in accordance with previously approved and issued Layout Drawing
- 2.** Position remaining beams using full depth Spacer blocks, bedded on mortar. Ensure beams are placed tightly against spacer block.
- 3.** Install Polystyrene infill blocks. Blocks can be cut with a hand saw to suit service holes and run out.
- 4.** Install edge blocks as denoted on the Layout Drawing, and overlay with polystyrene sheet.
- 5.** Ensure insulation strips are pinned to the underside of beams where required. See standard details issued with Layout Drawing.
- 6.** Bed split course blocks between beam ends for staggered bearings on internal walls.
- 7.** Create screed rail/formwork using either timber batten soleplate or bedded brick course.
- 8.** Lay structural concrete topping. Use grade 25 concrete reinforced with polypropylene fibres or grade 30 concrete with mesh. Do not pour from a height greater than 300mm.
- 9.** Float to final finish.
- 10.** This data sheet is a guide only and should be used in conjunction with specific quotation notes if applicable, and the relevant agreement certificate. All floors to be installed in accordance with current health and safety and CDM regulations. Full COSHH details are available on request.

Installation guide

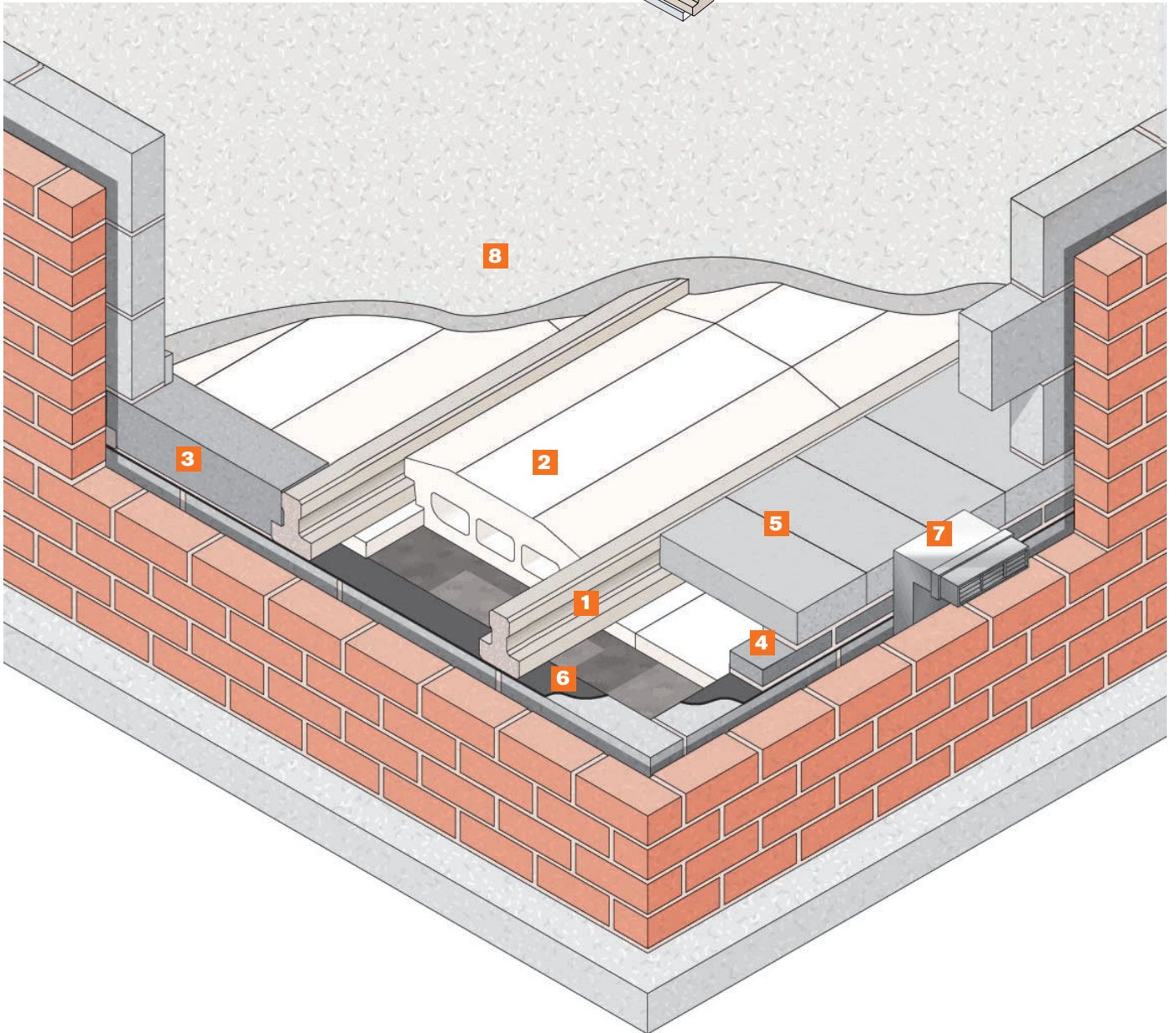
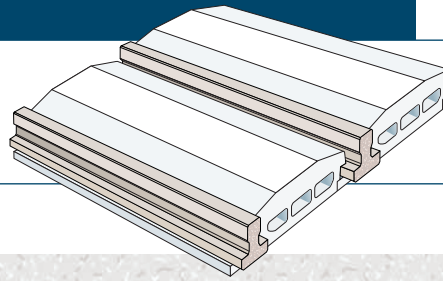

1. 150mm deep prestressed beam.
2. Jetfloor expanded polystyrene block.
3. Thermalite spacer block.
4. Split course block.
5. Thermalite edge block.
6. Damp proof course.
7. Void ventilator and air brick.
8. Structural concrete topping.